

DETAILS

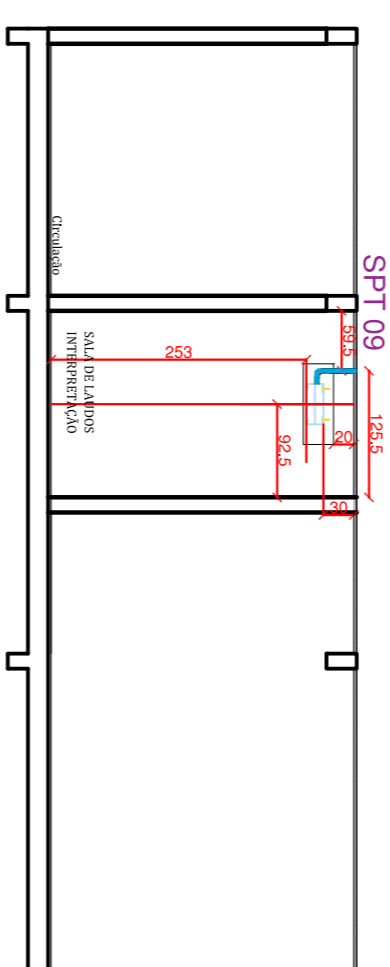

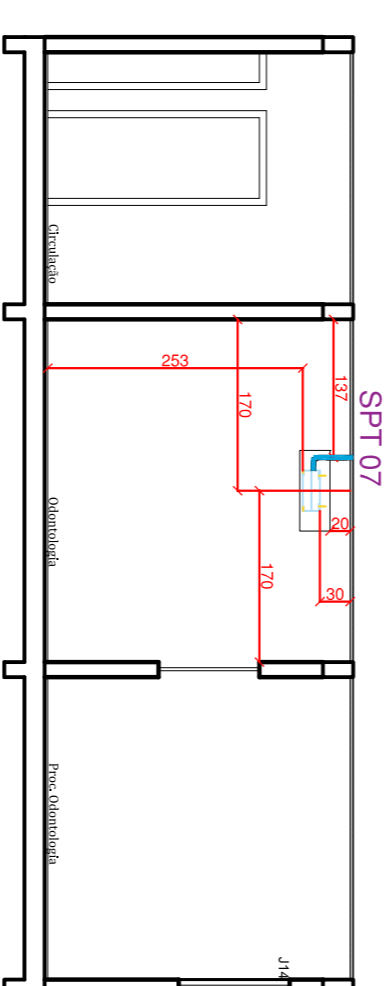
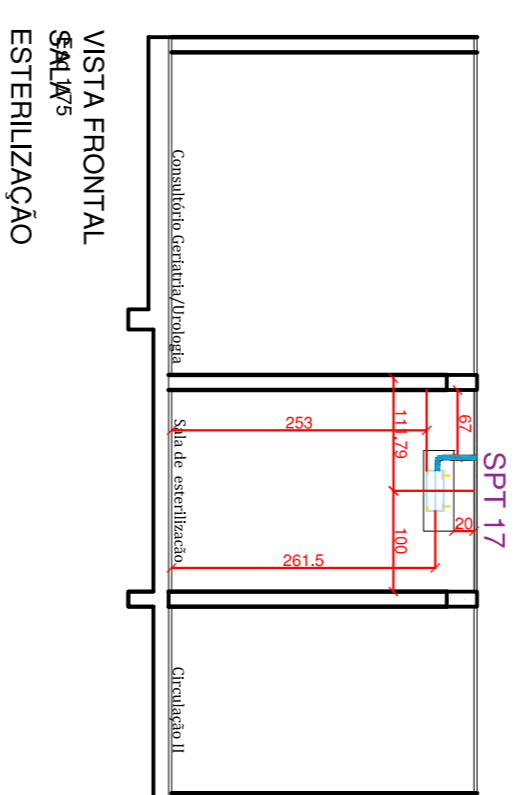
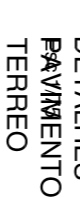
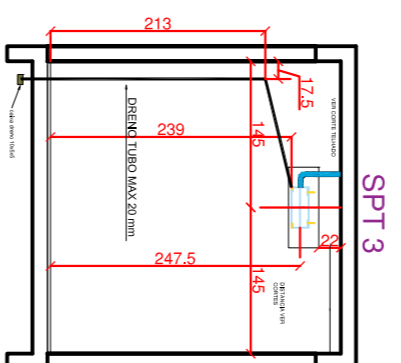
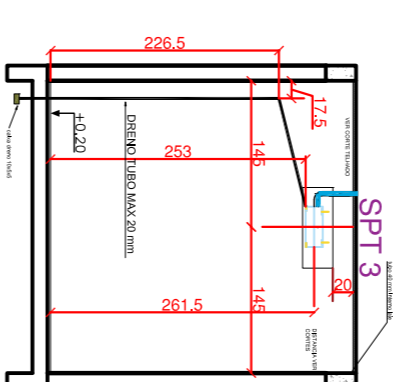
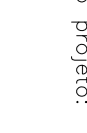

AL medi

COMPANHIA DE ATENDIMENTO MÉDICO E CONSULTORIA

ALMED - ATENDIMENTO MÉDICO E CONSULTORIA LTDA - ME

CNPJ: 06.904.180

Endereço: Rua Bepiara da Souza, 259

Paulo Branco - RJ

CEP: 65044-000

Telefone: (201) 2511-8110

E-mail: atendimento@almedi.com.br

Título: PROJETO DE CLIMATIZAÇÃO E FLUIDO MECÂNICO

Empreendimento: CENTRO DE ESPECIALIDADES

Endereço da Obra: R. CORONEL SANTHIAGO DANTAS, CENTRO, CHOPINIZINHO /PR

Área: 766,80M²

ESCOLA:	DATA:	DESEMPENHO:	PRONTO:
INDICADA	28/02/2018	Eduardo	
Autor do projeto:		Chefe Executivo Municipal:	
JUAZÉ REINALDO DA COSTA Eng. Mecânica CREA-PR 20.155/D		ALVARO DENIS CENI SCOLARO Presidente Municipal	

2/2